

COMBUSTION CHAMBER KIT

#5611401 REPLACEMENT KIT FOR STARFIRE II BOILER

AND

BURNER BLAST TUBE CHANGE INSTRUCTIONS

WARNING



This kit must be installed by a qualified installer or service agency, in accordance with the manufacturer's instructions, and in accordance with all codes and requirements of the authority having jurisdiction. Failure to follow these instructions could result in fire or explosion resulting in property damage, personal injury, or loss of life.

The StarFire II boiler came from the factory with multiple burner options. StarFire II boilers used Wayne Blue Angel or Beckett burners. The Beckett burners offered had 2 different blast tube assembly lengths depending on the model year. These instructions will explain how to correctly replace the blast tube.

IMPORTANT: Depending on the blast tube dimensions listed in this instruction, you may be required to contact your service dealer for replacement parts. Before beginning, fully read the instructions to determine if this applies to you.

IMPORTANT: Before beginning installation, verify that all components are present.

PARTS LIST - KIT #5611401

ITEM	PART NUMBER	DESCRIPTION	QTY
1	225-2-4.03	Mounting Door (14 ga aluminized CRS)	1
2	225-2-5.01	Mounting Door Insulation	1
3	215-1-9.01	Lower Front Panel (with insulation)	1
4	BN08002	Blast Tube	1
5	1250002	Gasket	1
6	2251401	Observation Door (with gasket)	1
7	14695074	#10 x 1/2" screw	2
	5611508	SFII Target Wall Kit (contents listed below)	1
8	2552701	Target Wall	1
9	25511005	Insulation Blanket	1
10	2751700	Target Wall Instructions	1

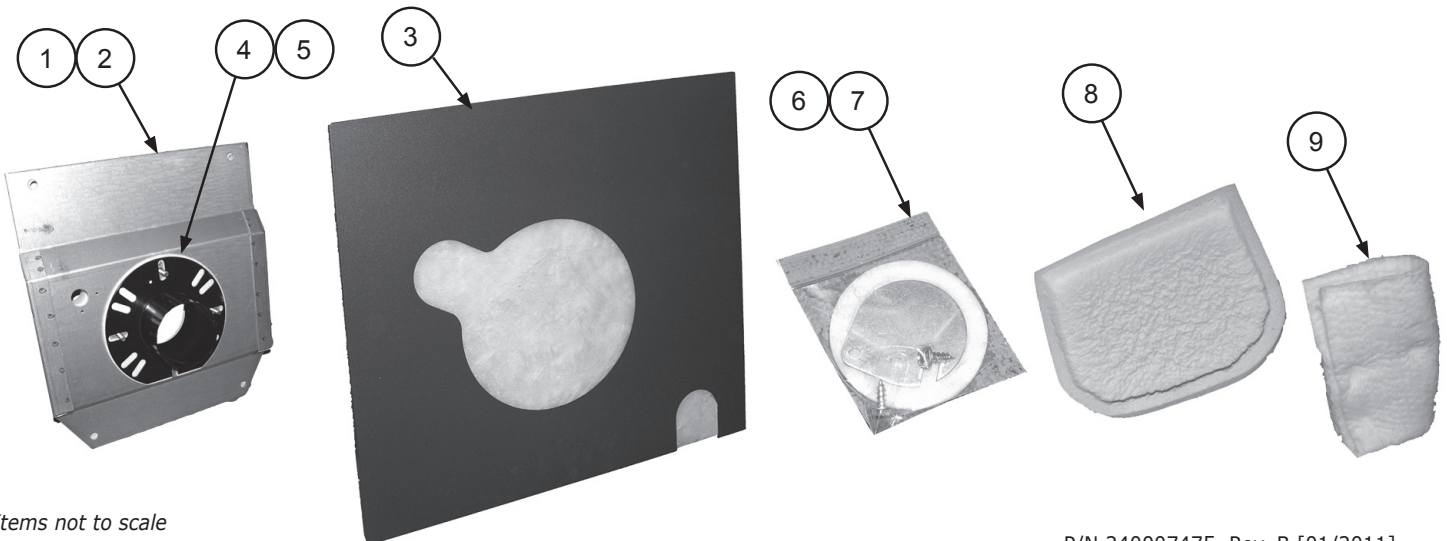

*Items not to scale

SFII COMBUSTION CHAMBER KIT #5611401

1. Fully read and understand all instructions before attempting to install this kit.
2. To remove the Lower Front Panel, Mounting Door and burner, refer to the instructions found in the Target Wall Kit. Perform steps 1-4.
3. **Important dimension requirements:**
 - A. The supplied blast tube overall dimension is 4".
 - B. The dimension from the flange to the end that goes inside the boiler is 1 1/2". **Note: the flange is not perpendicular to the blast tube.**
 - C. With the burner installed on the mounting door, the inside end of the blast tube must be recessed 1/4" to 3/8" from the mounting door insulation. See **Figure 1**.
 - D. The burner end cone **must not** protrude into the boiler further than the blast tube.
4. **IF A WAYNE BURNER IS INSTALLED**, contact your Wayne Combustion Systems dealer to request a new blast tube assembly with an adjustable flange that meets the dimension requirements in step 3.
5. **IF A BECKETT BURNER IS INSTALLED**, compare the installed blast tube with the kit-supplied blast tube.
 - A. If the installed blast tube is any length other than 4" overall, contact your Beckett dealer to purchase a new Blast Tube assembly for the required dimensions in step 3.
 - B. **ONLY** if the installed blast tube meets the required dimensions and is exactly the same as the kit supplied blast tube, replace the installed blast tube with the kit-supplied tube.
6. Once the blast tube requirements have been met, complete steps 5 thru 15 on the Target Wall instructions.

Figure 1 - Inside Mounting Door

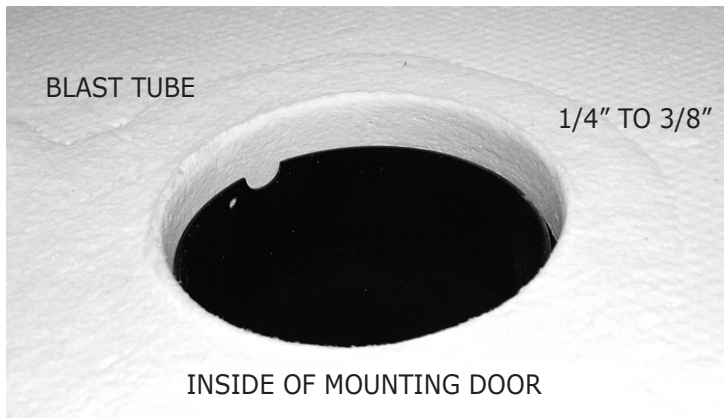

For technical assistance with this product call toll free 1-800-325-5479

ECR International
PO Box 4729
Utica, NY 13504-4729
www.ecrinternational.com