

ECR97 BLOWER REPLACEMENT KIT #550002192 INSTRUCTIONS

⚠ WARNING

Kit shall be installed by qualified service agency in accordance with manufacturer's instructions and all applicable codes and requirements of authority having jurisdiction. If information in these instructions is not followed exactly, a fire, explosion or production of carbon monoxide may result causing property damage, personal injury or loss of life. Qualified service agency is responsible for proper installation of this kit. Installation is not proper and complete until operation of appliance is checked as specified in manufacturer's instructions supplied with the kit.

⚠ CAUTION

Shut "OFF" gas supply prior to disconnecting electrical power, before proceeding.

Blower Replacement Instructions:

1. Tools Required:
 - (2) Crescent wrenches
 - Regular screwdriver
 - T25 Torx driver
 - 1/4" drive ratchet
 - 7/16" socket
 - 5/32" Allen wrench or socket
2. Follow instructions To Turn Off Gas to Appliance found on Operating Instructions label inside jacket or in Installation, Operation & Maintenance Manual. Verify all electrical power to boiler is turned off.
3. Turn OFF gas supply at manual main gas shutoff valve external to boiler.
4. Remove jacket. Grasp front cover at lip behind plastic smoke-colored control cover. Pull forward to release snap action latches. Lift cover up and off bottom jacket rest.
5. Fold control panel down by first lifting up slightly to clear top tab from notch in jacket then fold down. Completely remove lower control panel by aligning bottom control panel hinge/tab with relief slot cut in jacket. Push panel inward to slide hinges out of slots then angle panel up and out of boiler. See Figure 1.
6. Loosen retaining screw and disconnect gas valve wire harness from gas valve.
7. Disconnect flexible gas line from gas shutoff valve.

NOTICE

Use two (2) wrenches when loosening and tightening flexible gas line. Boiler's gas valve can be damaged if subjected to excessive torque.

Figure 1 - Internal Access Panel Closed with Latch

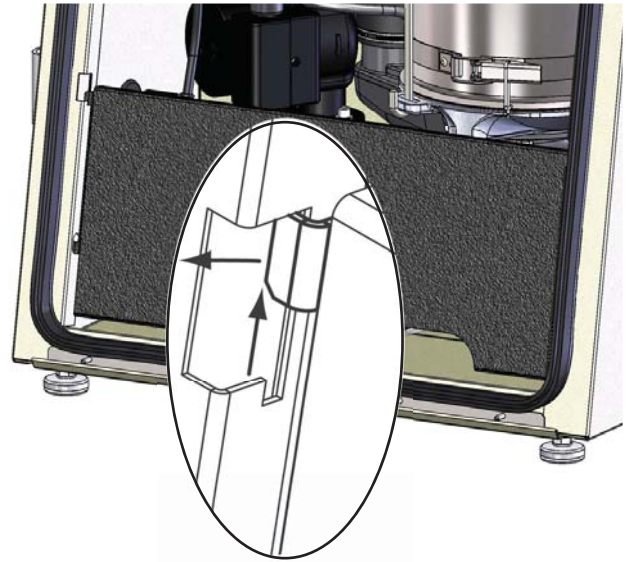
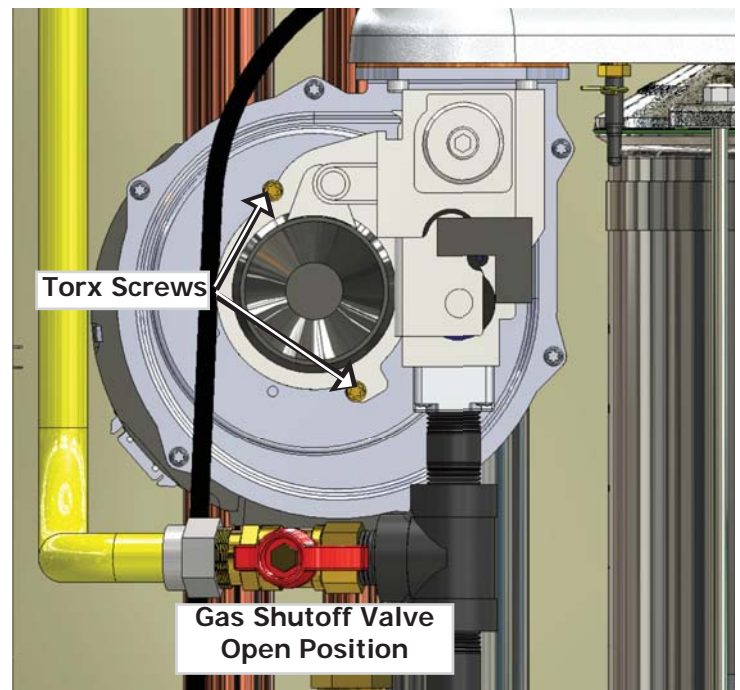

Figure 2 - Torx Screw Locations



ISO 9001-2008 Certified Company

ECR International, Inc.

2201 Dwyer Ave.

Utica, NY 13501



8. Disconnect two wire harness plugs from blower motor.
9. Remove (2) Torx T25 screws holding gas valve to blower. Remove gas valve. See Figure 2.
10. Disconnect 2 orange wires from pressure switch, if present. Set aside.
11. Remove pressure switch hose from air/fuel inlet barb fitting, if present.
12. Disconnect high voltage lead from igniter and flame rod.
13. Remove blower motor and air/fuel inlet assembly. Support blower motor/air inlet. Use 1/4" drive ratchet with 7/16" socket to remove (4) nuts holding air inlet to heat exchanger. Lift blower motor/air inlet off studs. See Figure 3.
14. Use 5/32" Allen wrench or socket to remove (4) cap screws holding blower motor to air/fuel inlet. See Figure 4.

Figure 3 - Blower with Air Inlet (Gas Valve Removed)

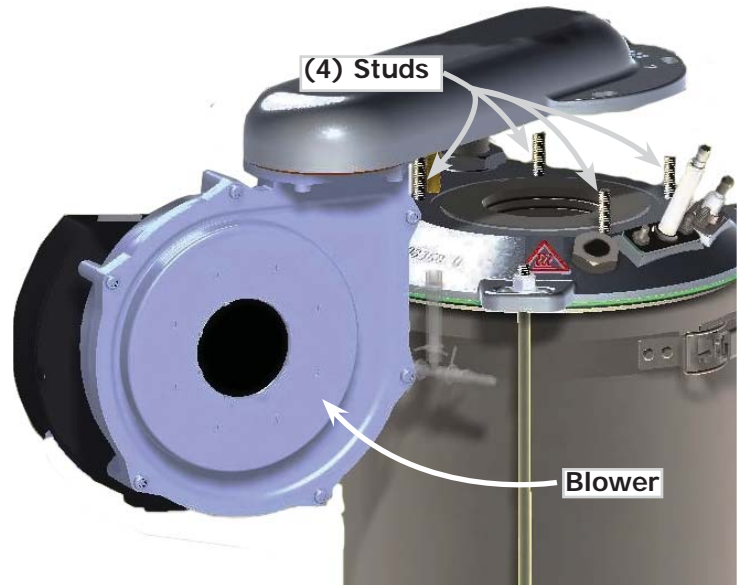

Figure 4 - Blower with Air Inlet

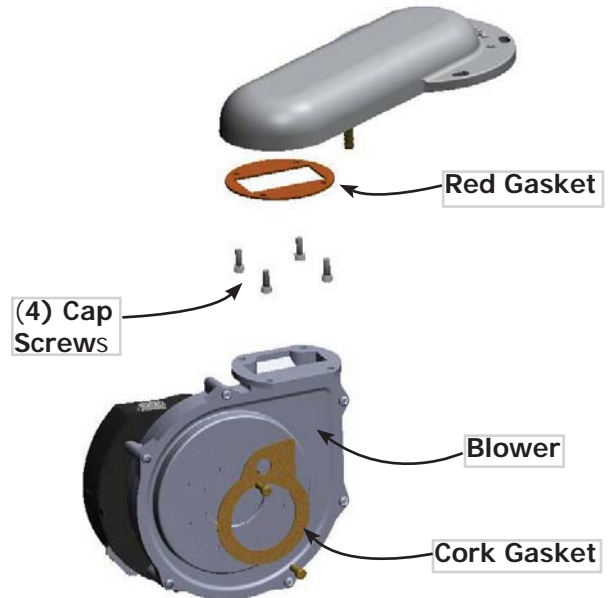
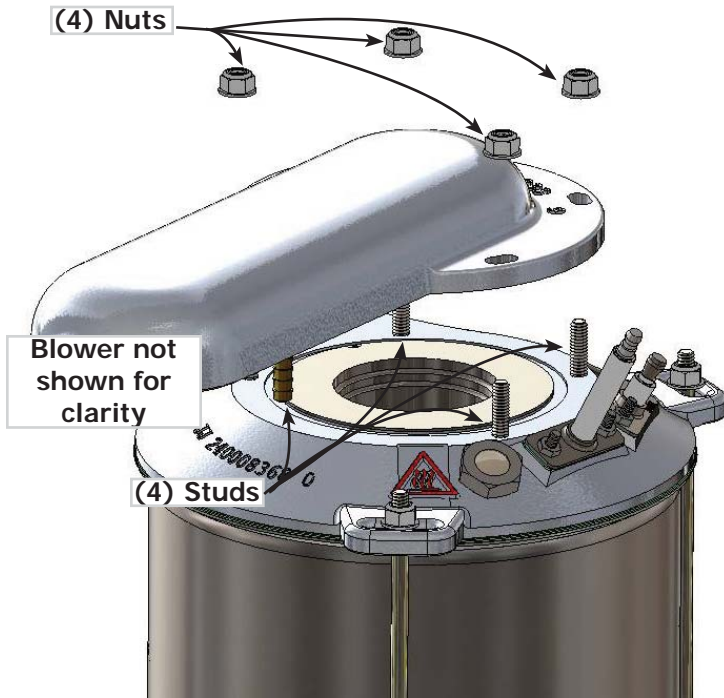

Figure 5 - Blower with Air/Fuel Inlet



Blower Reassembly Instructions:

1. Place red gasket to blower outlet. Align center opening and screw holes.
2. Attach air/fuel inlet to blower. Secure with (4) screws. See Figure 4.
3. Place air/fuel inlet gasket to blower/air inlet assembly. Place assembly onto heat exchanger studs. Secure with (4) nuts. Verify gasket does not shift. See Figure 5.
4. Connect 2 orange wires to pressure switch, if present.
5. Connect high voltage lead to igniter and flame rod.
6. Connect pressure switch hose to air/fuel inlet barb fitting, if present. Secure with rotor clamp.
7. Apply thin film of silicone at locations shown in Figure 6 to help hold cork gasket in place for gas valve. Use silicone sparingly; not necessary for sealing.
8. Align gas valve on blower. Attach with (2) Torx screws.
9. Connect (2) harnesses to blower motor.
10. Connect flexible gas line to gas shutoff valve.

NOTICE

Flexible gas line is flare connection, no pipe sealant is necessary.

Figure 6 -Gasket Valve and Flange

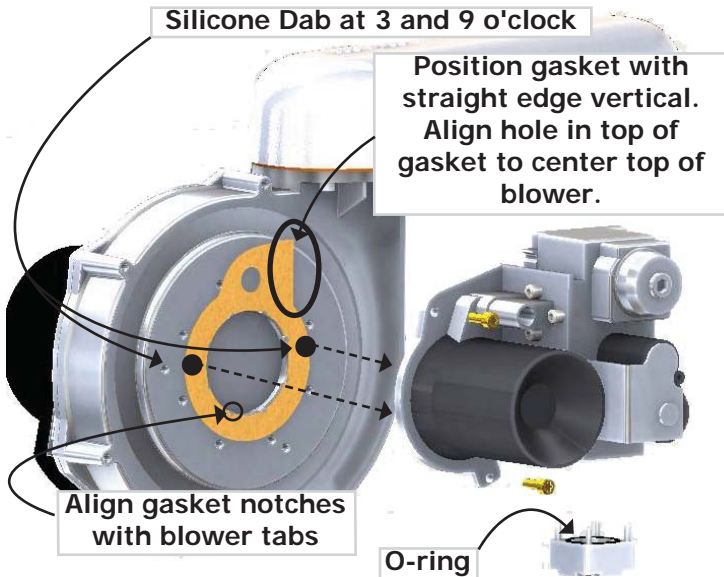

NOTICE

Verify proper operation after servicing.

13. Install jacket.

Figure 6 - Blower

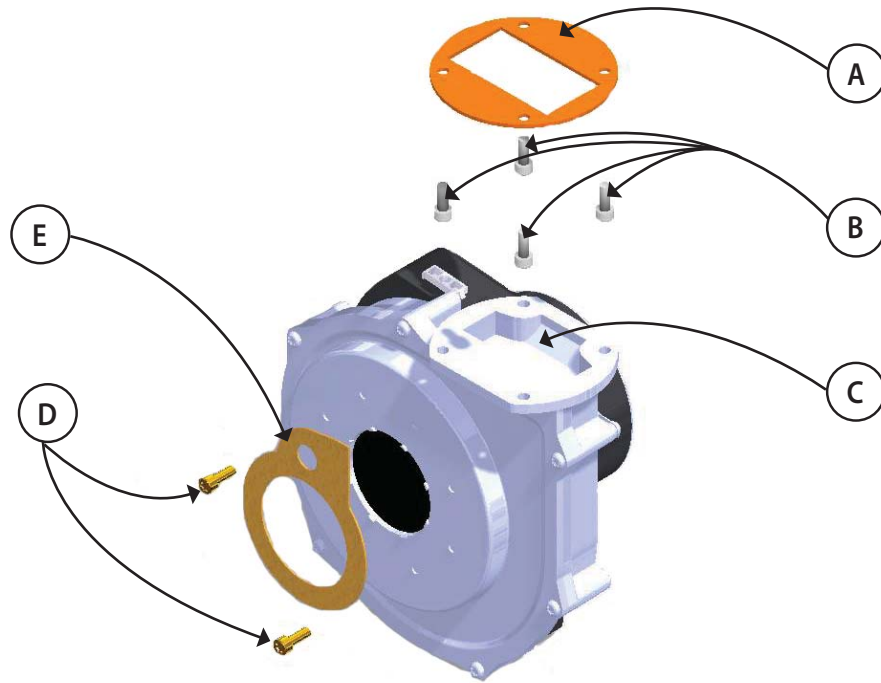

ECR97 Blower Kit #550002192 - Parts List			
ITEM	DESCRIPTION	PART #	QTY
A	Red Gasket, Fan/Transition Piece	1250007	1
B	Screw, 10-24 X 1/2" SS Socket Head Cap	-	4
C	Blower, 120 V 50/60 Hz	-	1
D	Screw, T25 Torx	-	2
E	Gasket, Cork	1250021	1
	Gasket, Air Fuel Inlet	240008251	1
	Nut, 1/4-20 Hex Washer	14695810	4
*	Instructions	240008594	1