

# REPLACEMENT BURNER KIT INSTRUCTIONS

050 Kit # 550002276

075 Kit # 550002277

100 Kit # 550002278

150/200 Kit # 550002279

Kit installation shall be completed by qualified agency.

## **⚠ WARNING**

Fire, explosion, asphyxiation and electrical shock hazard. Improper installation could result in death or serious injury. Read this instruction and understand all requirements, including requirements of authority having jurisdiction, before beginning installation. Installation not complete until appliance operation verified per Installation, Operation & Maintenance Manual provided with boiler.

Tools required:

- (2) Crescent wrenches
- 11/32" Nut Driver, Wrench or Socket
- Gasket Scraper
- Phillips Screwdriver
- 7/16" Deep Well Socket

1. Follow instructions TO TURN OFF GAS TO APPLIANCE found on Operating Instructions label on boiler or in Installation, Operation & Maintenance Manual. Verify all electrical power to boiler is turned off.

## **⚠ WARNING**

Electrical shock hazard. Turn OFF electrical power supply at service panel.

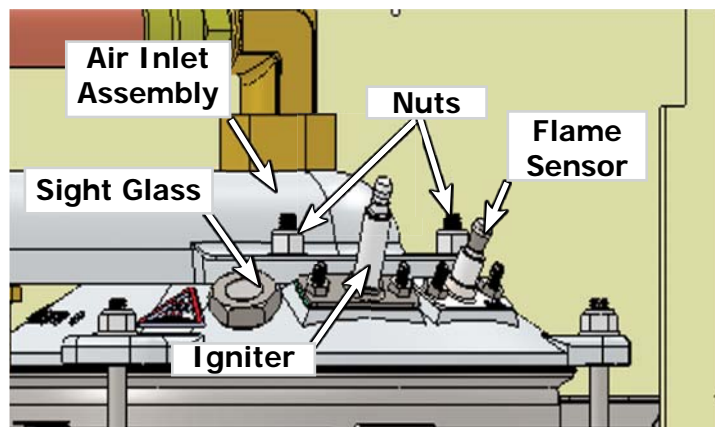
2. Remove front jacket panel(s).

## **⚠ WARNING**

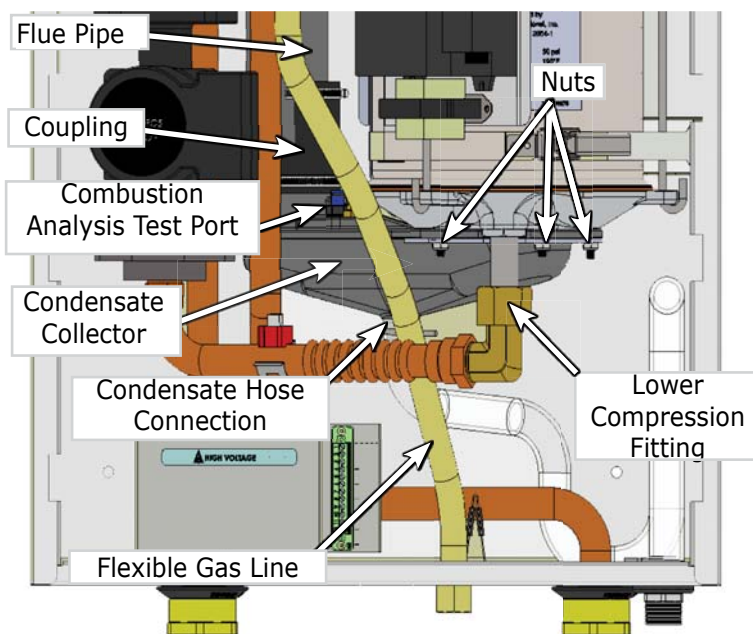
Burn hazard. Verify heat exchanger, igniter, and flame sensor have cooled or use appropriate personal protection equipment before removing.

3. Inspect combustion chamber through sight glass. Verify flame is not present. See figure 1.
4. Remove Igniter:
  - Disconnect igniter cable from igniter.
  - Remove two (2) 8-32 hex nuts using 11/32" nut driver, wrench or socket.
  - Pull igniter up and out of heat exchanger.
  - Remove old igniter gasket. Clean surface of heat exchanger where there is contact with the igniter gasket.

**Figure 1 - Sight Glass, Igniter & Flame Sensor**



**Figure 2 - Condensate Trap**



## REPLACEMENT BURNER KIT INSTRUCTIONS

5. Remove Flame Sensor.
  - Disconnect flame sensor cable from flame sensor.
  - Remove two (2) 8-32 hex nuts using 11/32" nut driver, wrench or socket. See figure 1.
  - Disconnect ground wire from stud.
  - Pull flame sensor out of heat exchanger.
6. Remove Gas Valve Harness. Loosen retaining screw and disconnect harness from gas valve.
7. Disconnect Flexible Gas Line. See figure 2
  - Turn off gas at main shutoff valve.
  - Disconnect flexible gas line from gas shutoff valve.

### NOTICE

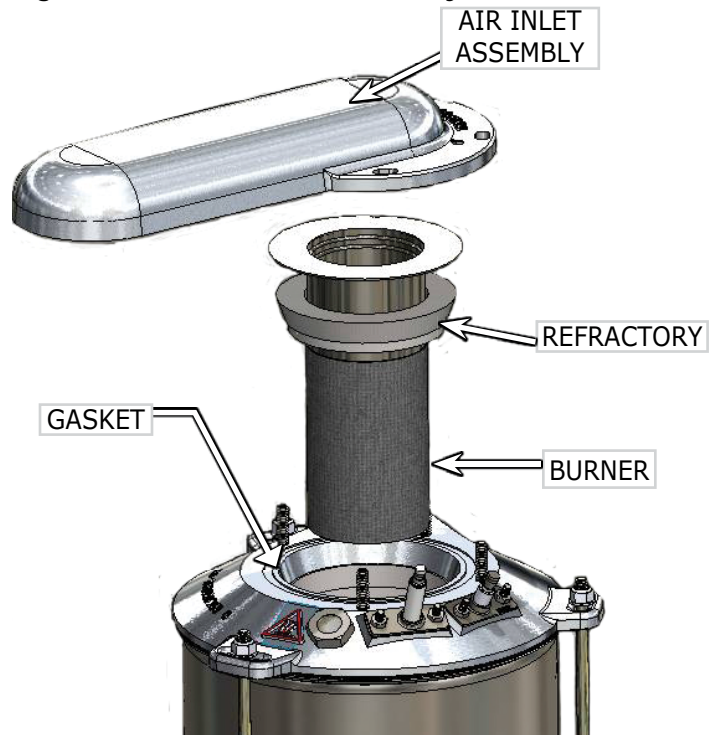
Use two (2) wrenches when tightening gas lines. Boiler components can be damaged if subjected to excessive torque.

8. Remove Air Inlet Assembly: See figure 4.
  - Disconnect two (2) harnesses from blower.
  - Support air inlet assembly. Remove four (4) ¼-20 hex flange nuts securing air inlet assembly to heat exchanger using 7/16" deep well socket.
9. Remove Burner
  - Remove gasket.
  - Lift burner from heat exchanger. Allow burner to clear top lip of chassis.
  - Remove any residual sleeve and/or gasket material from heat exchanger and air inlet assembly.
  - Slide new refractory burner sleeve onto new burner. See figure 3 for orientation.
  - Insert new burner into heat exchanger. Align U-shaped notch on burner flange with pin on heat exchanger. See figure 5.
10. Install Air Inlet Assembly
  - Replace existing burner gasket with new gasket provided with kit. Align gasket with studs in heat exchanger.
  - Place air inlet assembly onto heat exchanger. Secure hand tight with four (4) ¼-20 hex flange nuts. See figure 4.
  - Verify minimum ⅛" clearance between blower and piping. Complete tightening nuts.
11. Connect Flexible Gas Line
  - Connect flexible gas line to gas shutoff valve.

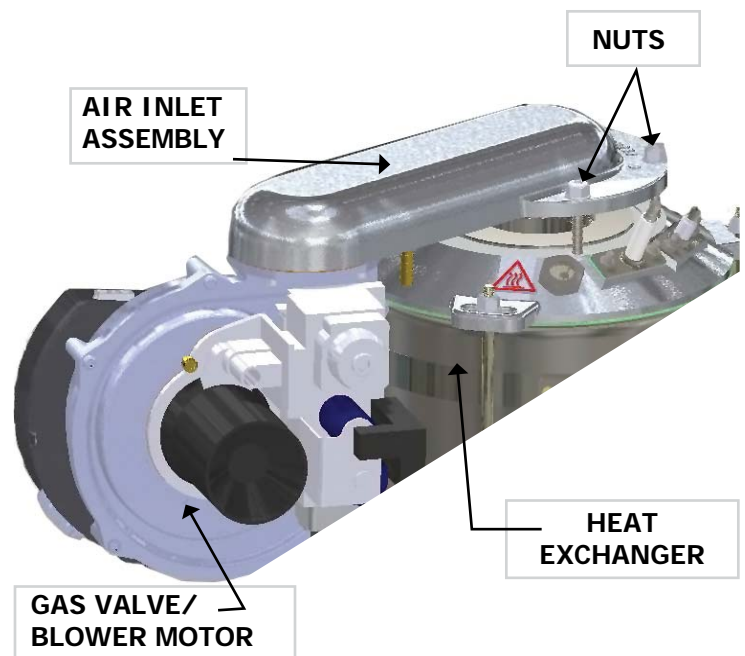
### NOTICE

Flexible gas line uses flare connection. No thread (joint) compound (pipe dope) necessary.

**Figure 3 - Burner with Refractory**

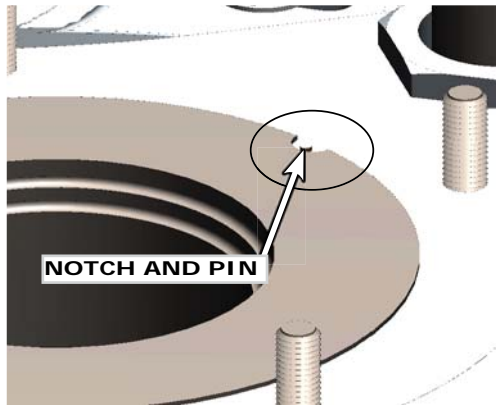


**Figure 4 - Air Inlet Assembly**

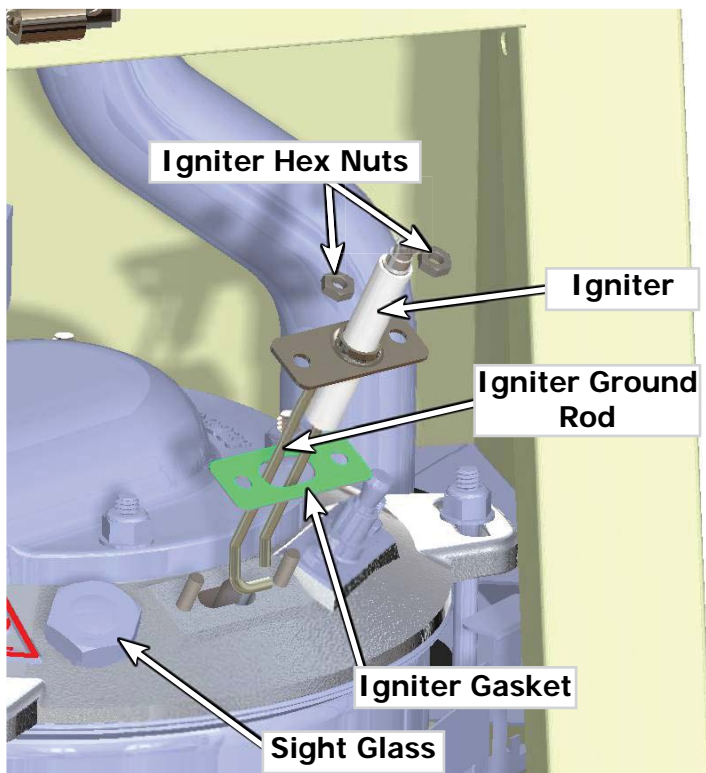


## REPLACEMENT BURNER KIT INSTRUCTIONS

**Figure 5 - Notch and Pin**



**Figure 6 - Igniter, Gasket and Hex Nuts**



**12. Install Flame Sensor:**

- Insert flame sensor into heat exchanger. Flame sensor bracket is off set and will only allow insertion in proper orientation.

### NOTICE

Flame sensor does not require gasket. Flame sensor o-ring seals flame sensor to heat exchanger.

**13. Install Igniter. See figure 6.**

- Position igniter gasket over igniter.
- Orient igniter with ground rod to left side.
- Insert igniter into heat exchanger. Secure with two (2) 8-32 hex nuts. Do not overtighten (maximum 5 lb-ft).
- Attach igniter cable to igniter.

**14. Gas Line Leak Test**

- Turn on gas at manual main gas shutoff valve.
- Check for gas line leaks using gas detector, noncorrosive detection fluid, or other leak detection method acceptable to authority having jurisdiction. Correct leaks immediately and retest.

### **⚠ DANGER**

Fire hazard. Do not use matches, candles, open flames, or other methods providing ignition source. Failure to comply will result in death or serious injury.

**15. General Finish Instructions**

- Resume operation using OPERATING INSTRUCTIONS found on Operating Instructions label on boiler or in Installation, Operation & Maintenance Manual.
- Verify proper operation by following START UP PROCEDURE in Installation, Operation & Maintenance Manual.
- Install front jacket panel(s).

## REPLACEMENT BURNER KIT INSTRUCTIONS

### PARTS LIST

<b>050 Replacement Burner Kit # 550002276</b>		
<b>DESCRIPTION</b>	<b>PART #</b>	<b>QTY</b>
8-32 Hex Nut	-	4
1/4-20 Hex Flange Nut	-	4
Igniter Gasket	-	1
Burner Gasket	-	1
Burner Sleeve, Refractory	-	1
Burner 50K BTU	-	1
Instructions	240008933	1
<b>075 Replacement Burner Kit # 550002277</b>		
8-32 Hex Nut	-	4
1/4-20 Hex Flange Nut	-	4
Igniter Gasket	-	1
Burner Gasket	-	1
Burner Sleeve, Refractory	-	1
Burner 75K BTU	-	1
Instructions	240008933	1
<b>100 Replacement Burner Kit # 550002278</b>		
8-32 Hex Nut	-	4
1/4-20 Hex Flange Nut	-	4
Igniter Gasket	-	1
Burner Gasket	-	1
Burner Sleeve, Refractory	-	1
Burner 100K BTU	-	1
Instructions	240008933	1
<b>150/200 Replacement Burner Kit # 550002279</b>		
8-32 Hex Nut	-	4
1/4-20 Hex Flange Nut	-	4
Igniter Gasket	-	1
Burner Gasket	-	1
Burner Sleeve, Refractory	-	1
Burner 150/200K BTU	-	1
Instructions	240008933	1

Check our website frequently for updates: [www.ecrinternational.com](http://www.ecrinternational.com)