

GAS VALVE KIT INSTRUCTIONS

050/075 Kit #550002285

100 Kit #550002286

150 Kit #550002287

200 Kit #550002288

Kit installation shall be completed by qualified agency.

⚠ WARNING

Fire, explosion, asphyxiation and electrical shock hazard. Improper installation could result in death or serious injury. Read this instruction and understand all requirements, including requirements of authority having jurisdiction, before beginning installation. Installation not complete until appliance operation verified per Installation, Operation & Maintenance Manual provided with boiler.

Tools required:

- 2 Crescent Wrenches
- Slotted Screwdriver
- Phillips Screwdriver
- Silicone Sealant
- T25 & T20 Torx Driver
- Combustion Analyzer

1. Follow instructions TO TURN OFF GAS TO APPLIANCE found on Operating Instructions label on boiler or in Installation, Operation & Maintenance Manual. Verify all electrical power to boiler is turned off.

⚠ WARNING

Electrical shock hazard. Turn OFF electrical power supply at service panel.

2. Remove front jacket panel(s).

⚠ WARNING

Burn hazard. Verify heat exchanger, igniter, and flame sensor have cooled or use appropriate personal protection equipment before removing.

3. Inspect combustion chamber through sight glass. Verify flame is not present. See figure 1.
4. Gas Valve Harness Removal.
 - Loosen retaining screw and disconnect harness from gas valve.
5. Disconnect Flexible Gas Line. See figure 2.
 - Turn off gas at manual main shutoff valve.
 - Disconnect flexible gas line from gas shutoff valve.

NOTICE

Use two (2) wrenches when tightening gas lines. Boiler components can be damaged if subjected to excessive torque.

Figure 1 - Sight Glass

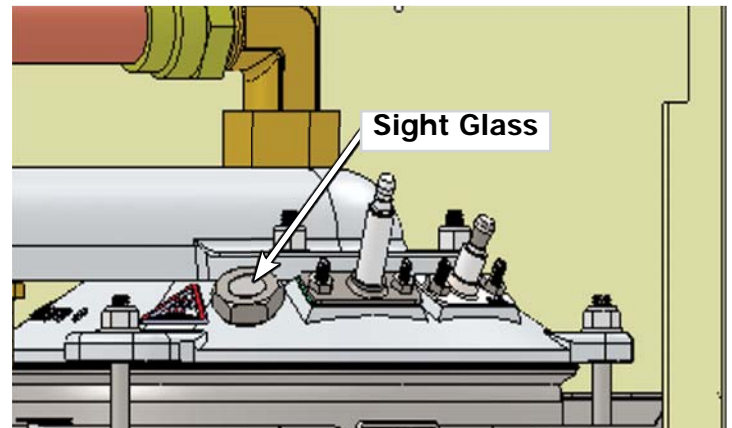
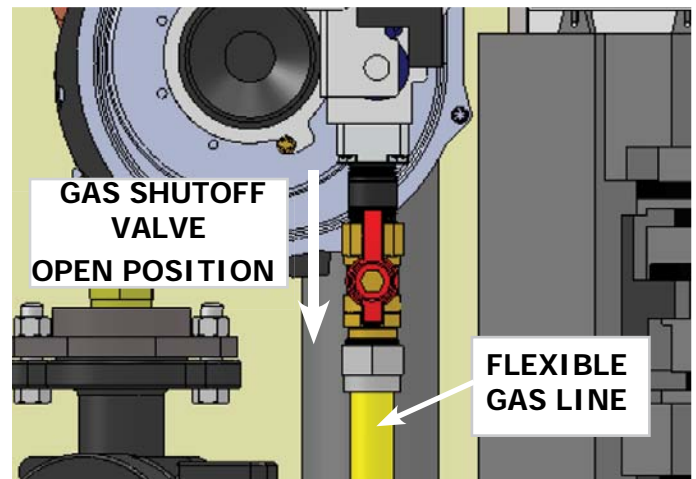

Figure 2 - Gas Shutoff Valve



GAS VALVE KIT INSTRUCTIONS

6. Remove Gas Valve and Valve Flange
 - Remove two (2) T25 Torx screws securing gas valve to blower. Remove gas valve. See figure 3.
 - Note orientation of gas shutoff valve handle to gas valve. Remove four (4) screws securing flange to gas valve. Remove gas shutoff valve assembly. See figure 4.
 - LP/Propane units only. Remove three (3) T20 Torx screws securing gas valve venturi to gas valve body. Separate venturi from valve body. Remove LP orifice from o-ring gasket.
7. Install New Gas Valve
 - LP/Propane units only. Remove three (3) T20 Torx screws securing replacement gas valve venturi to gas valve body. Separate venturi from valve body. Insert LP orifice into o-ring gasket. See figure 5. Attach venturi to gas valve body using three (3) T20 Torx screws.
 - Attach gas shutoff valve assembly to gas valve. Use existing o-ring or replace with o-ring provided with new flange in kit. Verify gas valve handle orientation per step 6 above. Secure with four (4) phillips screws.
 - Remove any residual cork gasket from blower. Surface must be clean to accept new cork gasket.
 - Apply thin film of silicone sealant to cork gasket. See figure 4. Use silicone sealant sparingly - helps hold gasket in place and is not necessary for sealing.
 - Align gas valve to blower. See figure 4. Secure with two (2) T25 Torx screws.
8. Install Flexible Gas Line
 - Connect flexible gas line to gas shutoff valve. See figure 2.

NOTICE

Flexible gas line uses flare connection. No thread (joint) compound (pipe dope) necessary.

9. Install Gas Valve Harness
 - Attach gas valve harness to gas valve. Secure with integral screw.
10. Gas Line Leak Test
 - Turn on gas at manual main gas shutoff valve.
 - Check for gas line leaks using gas detector, noncorrosive detection fluid, or other leak detection method acceptable to authority having jurisdiction. Correct leaks immediately.

DANGER

Fire hazard. Do not use matches, candles, open flames, or other methods providing ignition source. Failure to comply will result in death or serious injury.

Figure 3 - Torx Screw Locations

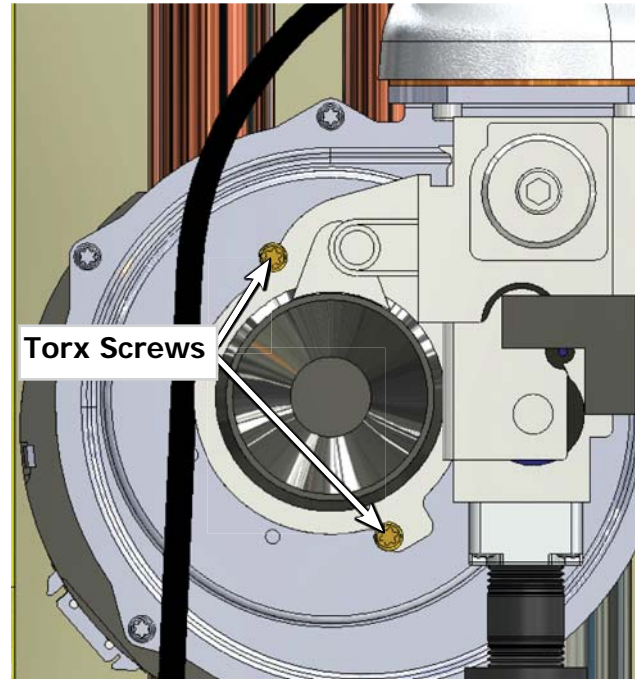
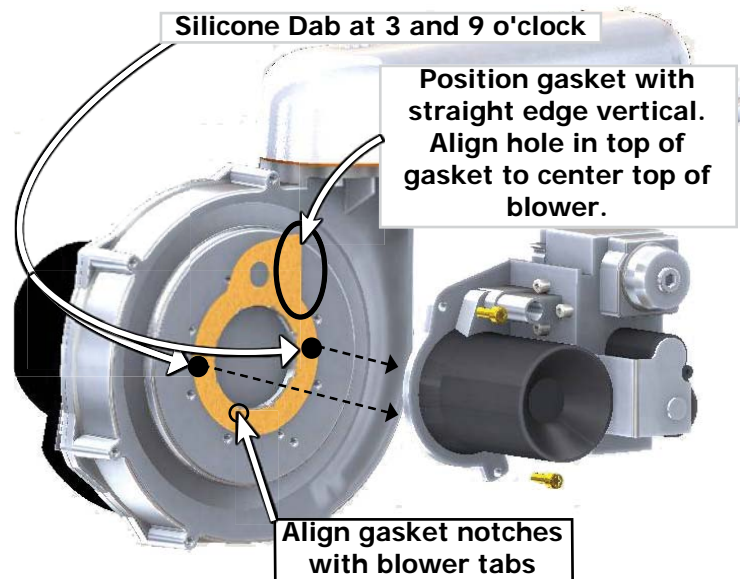
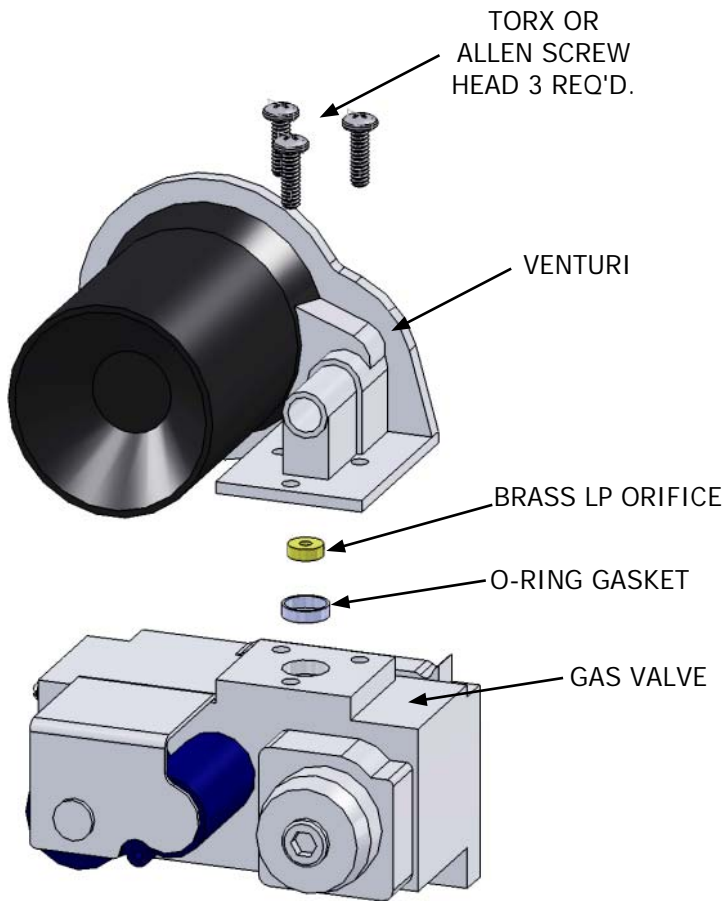

Figure 4 - Gasket, Valve, Flange



GAS VALVE KIT INSTRUCTIONS

Figure - 5 Disconnect Venturi Body from Gas Valve



NOTE: Brass orifice not required for Natural Gas

11. General Finish Instructions

- Resume operation using OPERATING INSTRUCTIONS found on Operating Instructions label on boiler or in Installation, Operation & Maintenance Manual.
- Verify proper operation by following START UP PROCEDURE in Installation, Operation & Maintenance Manual.
- Install front jacket panel(s).

GAS VALVE KIT INSTRUCTIONS

PARTS LIST

050 Gas Valve Kit # 550002329		
Gas Valve, 050, VK4115V	-	1
Gas Flange Kit	1235008	1
Screw, T25 Torx	-	2
Gasket, Cork	1250021	1
Instructions	240008939	1
075 Gas Valve Kit # 550002285		
DESCRIPTION	PART #	QTY
Gas Valve, 075, VK4115V	-	1
Gas Flange Kit	1235008	1
Screw, T25 Torx	-	2
Gasket, Cork	1250021	1
Instructions	240008939	1
100 Gas Valve Kit # 550002286		
Gas Valve, 100, VK4115V	-	1
Gas Flange Kit	1235008	1
Screw, T25 Torx	-	2
Gasket, Cork	1250021	1
Instructions	240008939	1
150 Gas Valve Kit # 550002287		
Gas Valve, 150, VK4115F	-	1
Gas Flange Kit	1235008	1
Screw, T25 Torx	-	2
Gasket, Cork	1250021	1
Instructions	240008939	1
200 Gas Valve Kit # 550002288		
Gas Valve, 200, VK4115F	-	1
Gas Flange Kit	1235008	1
Screw, T25 Torx	-	2
Gasket, Cork	1250021	1
Instructions	240008939	1