

BLOWER REPLACEMENT KIT INSTRUCTIONS

050/075/100 Kit #550002291

150 Kit #550002292

200 Kit #550002293 / 200 (High Altitude) Kit #550003058

Kit installation shall be completed by qualified agency.

⚠ WARNING

Fire, explosion, asphyxiation and electrical shock hazard. Improper installation could result in death or serious injury. Read this instruction and understand all requirements, including requirements of authority having jurisdiction, before beginning installation. Installation not complete until appliance operation verified per Installation, Operation & Maintenance Manual provided with boiler.

Tools Required:

- 2 Crescent Wrenches
 - Slotted Screwdriver
 - Phillips Screwdriver
 - Silicone Sealant
 - T25 Torx Driver
1. Follow instructions TO TURN OFF GAS TO APPLIANCE found on Operating Instructions label on boiler or in Installation, Operation & Maintenance Manual. Verify all electrical power to boiler is turned off.

⚠ WARNING

Electrical shock hazard. Turn OFF electrical power supply at service panel.

2. Remove front jacket panel(s).

⚠ WARNING

Burn hazard. Verify heat exchanger, igniter, and flame sensor have cooled or use appropriate personal protection equipment.

3. Inspect combustion chamber through sight glass. Verify flame is not present. See Figure 1.
4. Disconnect Gas Valve Harness. Loosen retaining screw and disconnect harness from gas valve.
5. Disconnect Flexible Gas Line
 - Turn off gas at manual main shutoff valve.
 - Disconnect flexible gas line from gas shutoff valve.

NOTICE

Use two (2) wrenches when loosening and tightening flexible gas line. Boiler components can be damaged if subjected to excessive torque.

6. Remove Gas Valve. Remove two (2) T25 Torx screws securing gas valve to blower. Remove gas valve. See Figure 2.

Figure 1 Sight Glass

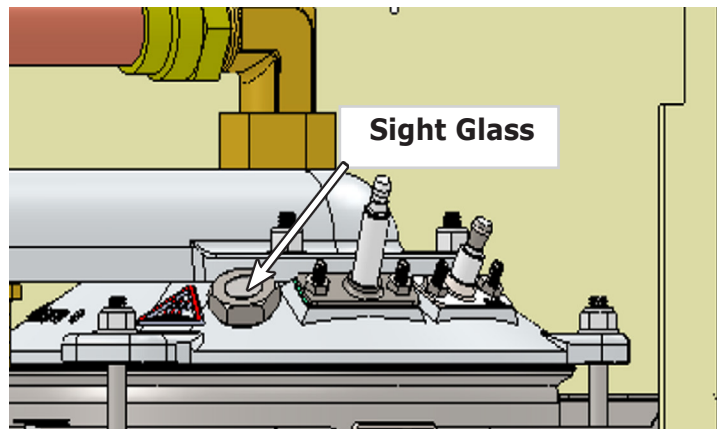
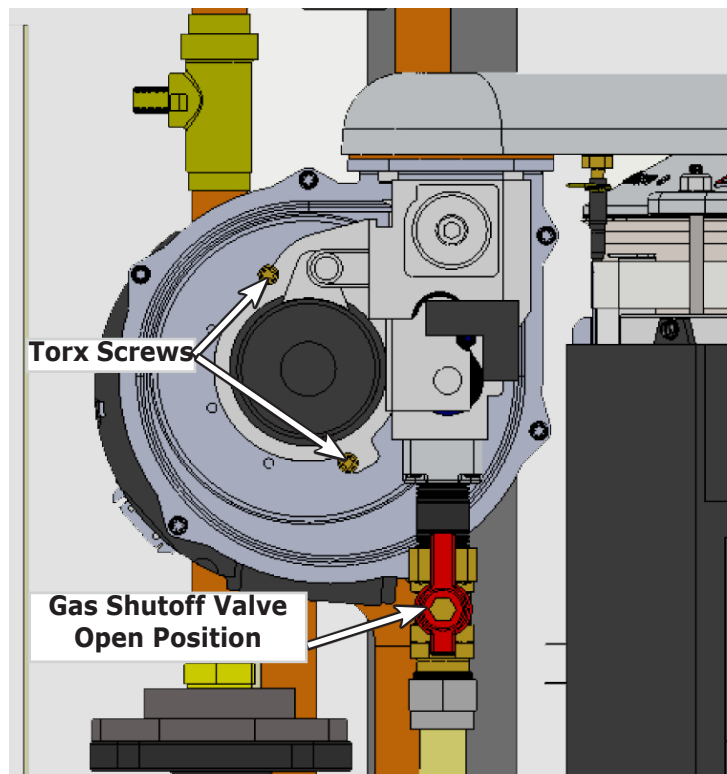

Figure 2 Torx Screw Locations



BLOWER REPLACEMENT KIT INSTRUCTIONS

7. Remove Air Inlet Assembly

- Disconnect igniter cable from igniter. Disconnect flame sensor cable from flame sensor.
- Disconnect two (2) harnesses from blower.
- Support air inlet assembly. Remove four (4) ¼-20 hex flange nuts securing air inlet assembly to heat exchanger using 7/16" deep well socket.

8. Remove Blower

- Note or mark alignment of blower outlet to air inlet.
- Remove four (4) 10-24 cap screws securing blower to air inlet using 4mm Allen wrench.

9. Install New Blower. See Figure 4.

- Place new red gasket to blower outlet. Align center opening and screw holes.
- Place air inlet to blower outlet with alignment noted or marked in step 8 above. Secure with four (4) 10-32 x ½" cap screws using 4mm Allen wrench.

10. Install Air Inlet Assembly

- Replace existing burner gasket with new gasket provided with kit. Align gasket with studs in heat exchanger.
- Place air inlet assembly onto heat exchanger. Secure hand tight with four (4) ¼-20 hex flange nuts. See Figure 5, page 3.
- Verify minimum ⅛" clearance between blower and piping. Complete tightening nuts.
- Connect two (2) harnesses to blower. Attach flame sensor cable to flame sensor. Attach igniter cable to igniter

11. Install Gas Valve

- Remove any residual cork gasket from blower. Surface must be clean to accept new cork gasket.
- Apply thin film of silicone sealant to cork gasket. See figure 6 page 3. Use silicone sealant sparingly - helps hold gasket in place and is not necessary for sealing.
- Align gas valve to blower. See Figure 6, page 3. Secure with two (2) T25 Torx screws.

12. Install Flexible Gas Line. Connect flexible gas line to gas shutoff valve. See Figure 2, page 1.

NOTICE

Flexible gas line uses flare connection. No thread (joint) compound (pipe dope) necessary.

13. Install Gas Valve Harness. Attach gas valve harness to gas valve. Secure with integral screw.

Figure 3 Blower (Gas Valve Removed)

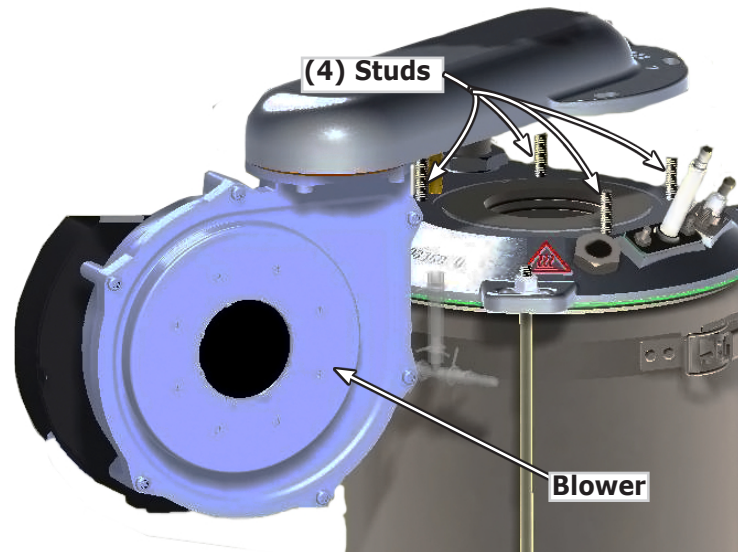
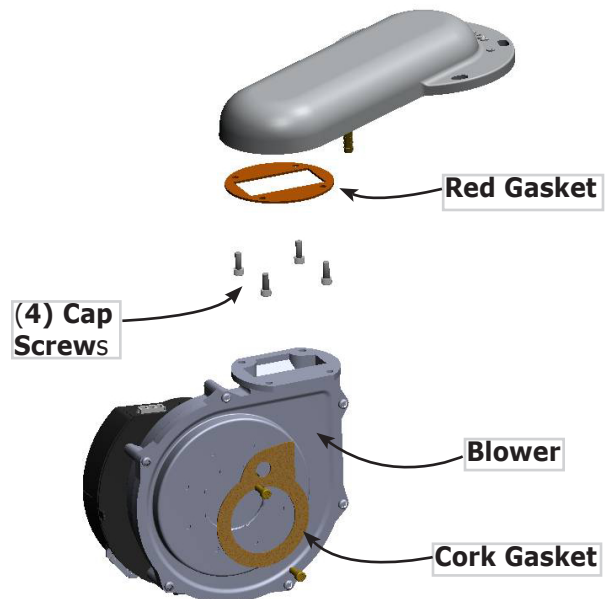
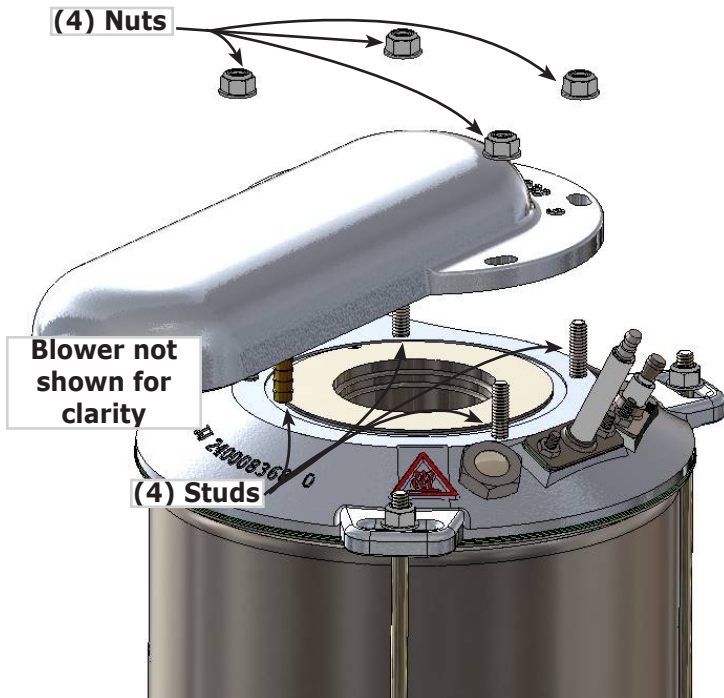

Figure 4 Blower with Air Inlet



BLOWER REPLACEMENT KIT INSTRUCTIONS

Figure 5 Blower with Air Inlet



14. Gas Line Leak Test

- Turn on gas at manual main gas shutoff valve.
- Check for gas line leaks using gas detector, noncorrosive detection fluid, or other leak detection method acceptable to authority having jurisdiction. Correct leaks immediately.

⚠ DANGER

Fire hazard. Do not use matches, candles, open flames, or other methods providing ignition source. Failure to comply will result in death or serious injury.

15. General Finish Instructions

- Resume operation using OPERATING INSTRUCTIONS found on Operating Instructions label on boiler or in Installation, Operation & Maintenance Manual.
- Verify proper operation by following START UP PROCEDURE in Installation, Operation & Maintenance Manual.
- Install front jacket panel(s).

Figure 6 Gasket Valve and Flange

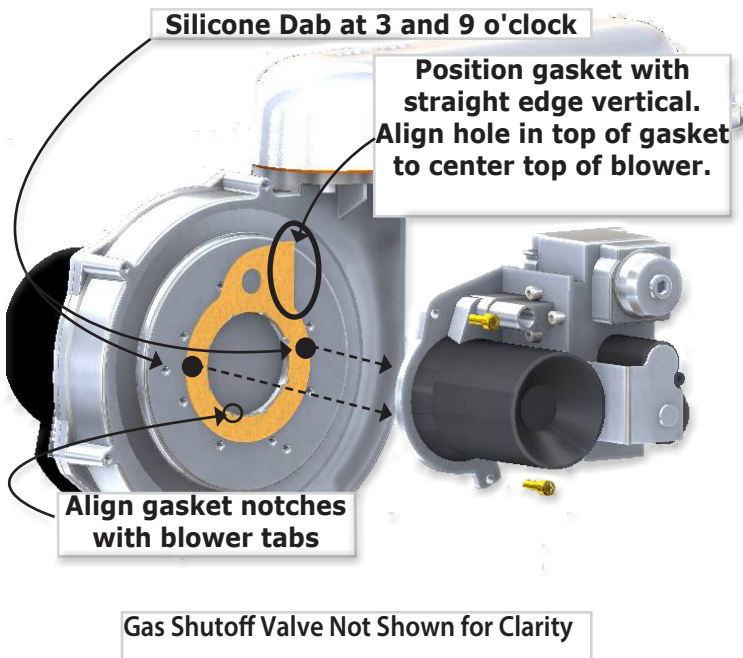

BLOWER REPLACEMENT KIT INSTRUCTIONS

Figure 7 Blower

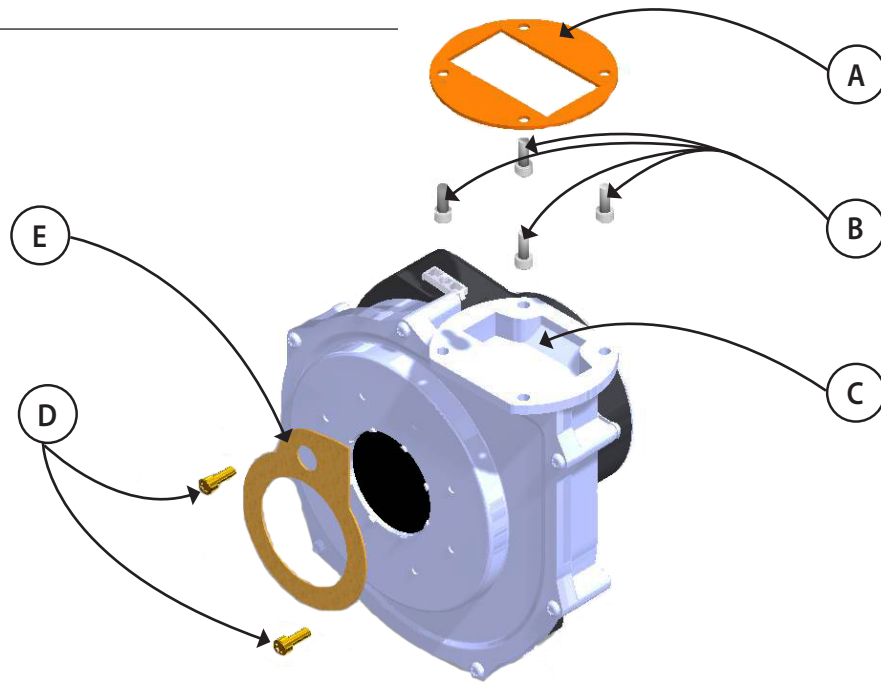

050/075/100 Blower Kit # 550002291		
DESCRIPTION	PART #	QTY
Red Gasket	1250007	1
Screw,10-24 X 1/2" Cap	-	4
Blower, 120 V 50/60 HZ, RG130/0800-3612	-	1
Screw, T25 Torx	-	2
¼-20 Hex Flange Nut	-	4
Gasket, Cork	1250021	1
Burner Gasket	-	1
Instructions	240008943	1
150 Blower Kit # 550002292		
DESCRIPTION	PART #	QTY
Red Gasket	1250007	1
Screw,10-24 X 1/2" Cap	-	4
Blower, 120 V 50/60 HZ, RG148/1200-3612	-	1
Screw, T25 Torx	-	2
¼-20 Hex Flange Nut	-	4
Gasket, Cork	1250021	1
Burner Gasket	-	1
Instructions	240008943	1

200 Blower Kit # 550002293		
DESCRIPTION	PART #	QTY
Red Gasket	1250007	1
Screw,10-24 X 1/2" Cap	-	4
Blower, 120 V 50/60 HZ, RG148/1200-3633	-	1
Screw, T25 Torx	-	2
¼-20 Hex Flange Nut	-	4
Gasket, Cork	1250021	1
Burner Gasket	-	1
Instructions	240008943	1
200 Blower (High Altitude) Kit # 550003058		
DESCRIPTION	PART #	QTY
Red Gasket	1250007	1
Screw,10-24 X 1/2" Cap	-	4
Blower, 130 V 50/60 HZ, RG148/1200-3633	-	1
Screw, T25 Torx	-	2
¼-20 Hex Flange Nut	-	4
Gasket, Cork	1250021	1
Burner Gasket	-	1
Instructions	240008943	1