

# CONDENSATE COLLECTOR KIT INSTRUCTIONS

050/075/100 Kit #550002294

150/200 Kit #550002295

Kit installation shall be completed by qualified agency.

## **⚠ WARNING**

Fire, explosion, asphyxiation and electrical shock hazard. Improper installation could result in death or serious injury. Read this instruction and understand all requirements, including requirements of authority having jurisdiction, before beginning installation. Installation not complete until appliance operation verified per Installation, Operation & Maintenance Manual provided with boiler.

Tools required:

- Spring Hose Clamp Pliers
- Silicone Sealant
- 3/8" Socket with 6" Extension
- 7/16" Deep Well Socket

1. Follow instructions TO TURN OFF GAS TO APPLIANCE found on Operating Instructions label on boiler or in Installation, Operation & Maintenance Manual. Verify all electrical power to boiler is turned off.

## **⚠ WARNING**

Electrical shock hazard. Turn OFF electrical power supply at service panel.

2. Remove front jacket panel(s).

## **⚠ WARNING**

Burn hazard. Verify heat exchanger has cooled or use appropriate personal protection equipment.

3. Inspect combustion chamber through sight glass. Verify flame is not present. See figure 1.
4. Condensate Trap Disconnect
  - Expand upper collect clip using hose clamp pliers. Disconnect condensate trap from condensate collector.
5. Condensate Collector Removal
  - Disconnect wire harness from vent temperature sensor. See figure 2.
  - Loosen upper hose clamp securing condensate collector to flue pipe using 3/8" socket with 6" extension. See figure 2.
  - Remove ¼-20 hex flange nuts securing condensate collector to heat exchanger using 7/16" deep well socket. See figure 3.
  - Remove condensate collector assembly from heat exchanger and flue pipe.

**Figure 1 - Sight Glass**

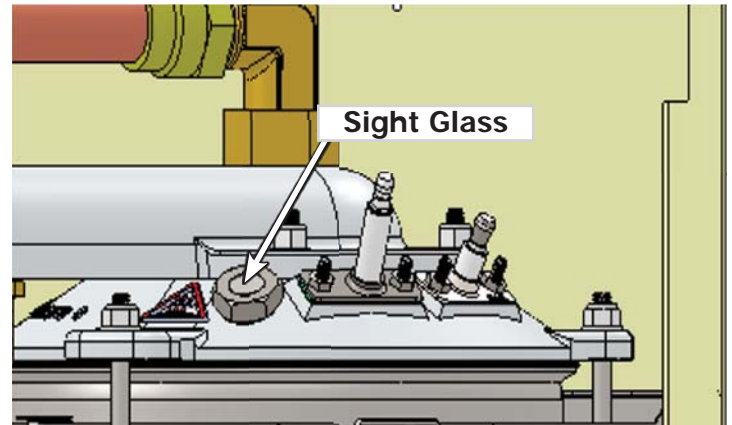

**Figure 2 - Condensate Trap**

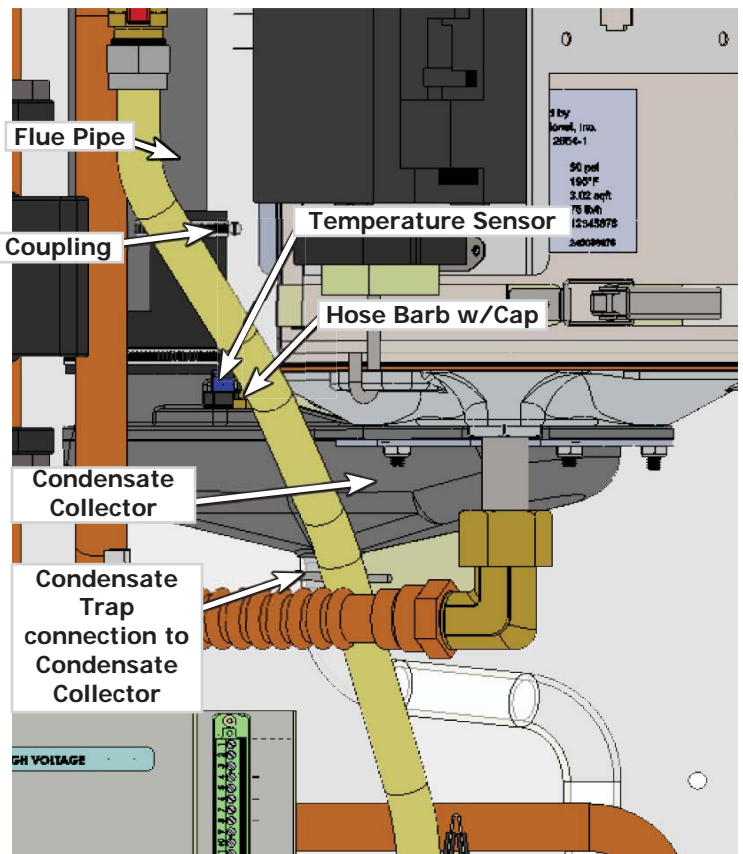

## CONDENSATE COLLECTOR KIT INSTRUCTIONS

### 6. Install New Condensate Collector

- Place flexible coupling and hose clamps onto condensate collector assembly. Tighten lower hose clamp. See figure 4.
- Apply thin film of silicone sealant to condensate collector recess. Place new o-ring into recess. See figure 4. Use silicone sealant sparingly - helps hold o-ring in place and is not necessary for sealing.
- Position condensate collector assembly under heat exchanger. Push assembly over heat exchanger studs while engaging flexible coupling onto flue pipe. Place flue collector bracket over studs. Secure with ¼-20 hex flange nuts. Do not over tighten. See figure 3.
- Verify flue pipe is fully seated into flexible coupling. Tighten upper hose clamp.
- Attach wire harness to vent temperature sensor.

### 7. Condensate Trap Connection

- Expand collet clip and place over end of condensate trap. Insert condensate trap onto condensate collector barb. Secure with collet clip.

### 8. General Finish Instructions

- Resume operation using OPERATING INSTRUCTIONS found on Operating Instructions label on boiler or in Installation, Operation & Maintenance Manual.
- Verify proper operation by following START UP PROCEDURE in Installation, Operation & Maintenance Manual.
- Install front jacket panel(s).

**Figure 3 - Push Upward onto Studs**

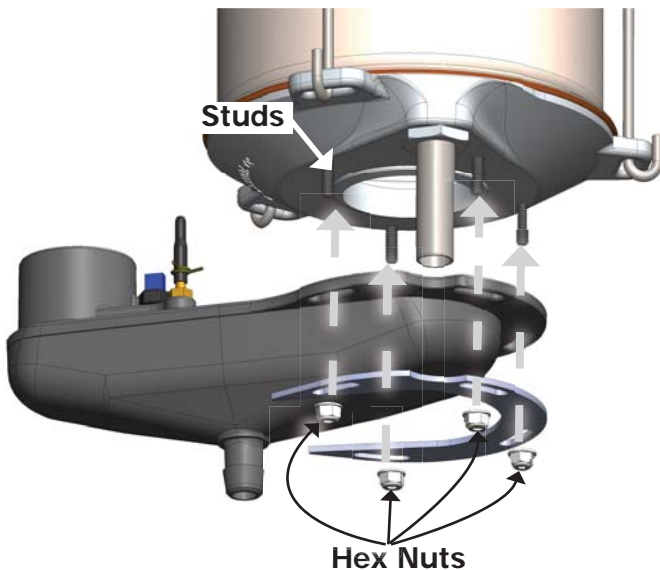

**Figure 4 - O-Ring Placement**

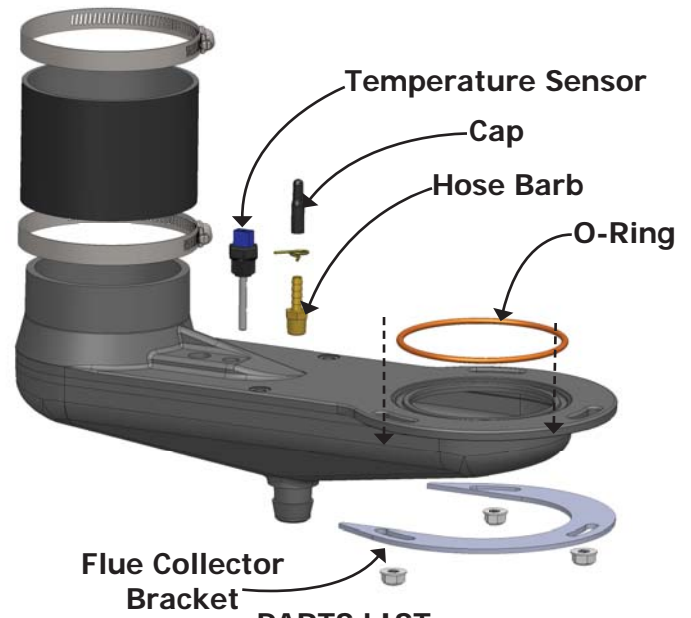

### PARTS LIST

#### 050/075/100 Condensate Collector Kit # 550002294

DESCRIPTION	PART #	QTY
Flexible Coupling	-	1
Hose Clamp	-	2
Hose Barb	1230010	1
Black Vinyl Cap	1230006	1
Spring Clamp, Small	1110001	1
Vent Temperature Sensor	240008227	1
Condensate Collector	-	1
¼-20 Hex Flange Nut	-	4
O-Ring	240008261	1
Flue Collector Bracket	109008777	1
Instructions	240008946	1

#### 150/200 Condensate Collector Kit # 550002295

DESCRIPTION	PART #	QTY
Flexible Coupling	-	1
Hose Clamp	-	2
Hose Barb	1230010	1
Black Vinyl Cap	1230006	1
Spring Clamp, Small	1110001	1
Vent Temperature Sensor	240008227	1
Condensate Collector	-	1
¼-20 Hex Flange Nut	-	3
O-Ring	240008699	1
Flue Collector Bracket	109008776	1
Instructions	240008946	1