

# THREE WAY VALVE MOTOR REPLACEMENT KIT #550003166 INSTRUCTIONS HEAT ONLY & COMBI CONDENSING, WALL MOUNTED, GAS BOILER

Kit installation shall be completed by qualified agency.

## ⚠ WARNING

Fire, explosion, asphyxiation and electrical shock hazard. Improper installation could result in death or serious injury. Read this instruction and understand all requirements, including requirements of authority having jurisdiction, before beginning installation. Installation not complete until appliance operation verified per Installation, Operation & Maintenance Manual provided with boiler.

1. Follow instructions TO TURN OFF GAS TO APPLIANCE found on Operating Instructions label on boiler or in Installation, Operation & Maintenance Manual. Verify all electrical power to boiler is turned off.

## ⚠ WARNING

Electrical shock hazard. Turn OFF electrical power supply at service panel.

2. Turn power and gas off to appliance.
3. Remove two (2) screws at bottom of front jacket cover. Lift jacket up and off.

## ⚠ WARNING

Burn hazard. Verify heat exchanger, igniter, and flame sensor have cooled or use appropriate personal protection equipment before removing.

4. Inspect combustion chamber through sight glass. Verify flame is not present. See figure 1.
5. Press tab and place control panel in downward position. See Figure 2.
6. 3 way valve and motor are located bottom left behind control panel. See Figure 3.
7. Remove retainer clip holding the motor onto the valve.
8. Remove motor from valve.
9. Remove electric plug from motor.
10. Install replacement electric plug into new motor.
11. Place motor onto 3 way valve.
12. Secure new motor to valve assembly using new retaining clip.
13. Restore control panel to upright position.
14. Restore power and gas to the appliance.
15. Resume operation using OPERATING INSTRUCTIONS found on Operating Instructions label on boiler or in Installation, Operation & Maintenance Manual.
16. Verify proper operation by following START UP PROCEDURE in Installation, Operation & Maintenance Manual.
17. Install front panel. Secure with two screws at bottom of front panel.

**Figure 1 - Sight Glass & Heat Exchanger Cover**

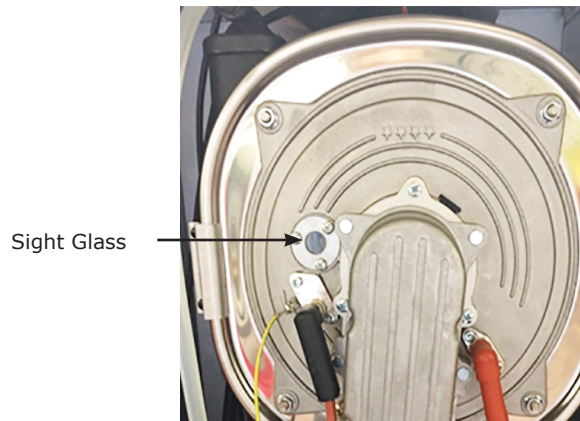

**Figure 2 - Control Panel and Tab**

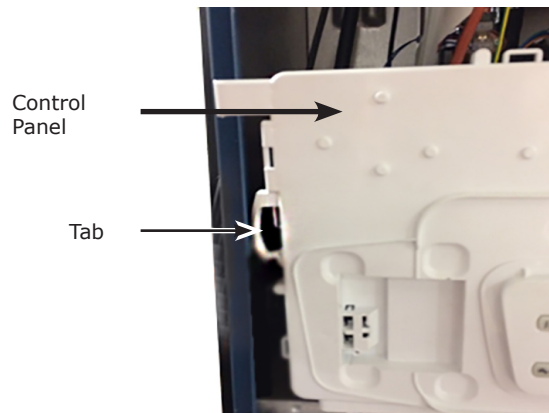

**Figure 3 - Combi 3 Way Valve Motor**

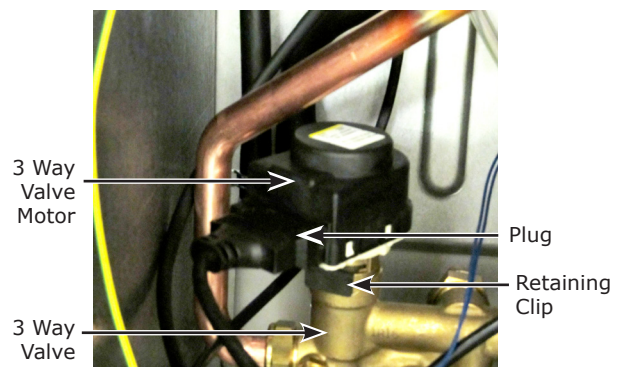

**THREE WAY VALVE MOTOR REPLACEMENT KIT INSTRUCTIONS**

<b>3-Way Valve Motor Replacement Kit 550003166 -Includes:</b>		
<b>Description</b>	<b>PART #</b>	<b>Qty</b>
3 WAY VALVE MOTOR 120V	-	1
CLIP-RETAINING (3 WAY VALVE)	-	1
3-WAY VALVE MOTOR REPLACEMENT KIT INSTRUCTIONS	240011406	1

Check our website frequently for updates: [www.ecrinternational.com](http://www.ecrinternational.com)