

# CCB/CHB REPLACEMENT COMBUSTION COVER KIT INSTRUCTIONS

**550003447 - CCB/CHB 150**  
**550003448 - CHB 100**  
**550003449 - CHB 130**

Kit installation shall be completed by qualified agency.

## ⚠ WARNING

Fire, explosion, asphyxiation and electrical shock hazard. Improper installation could result in death or serious injury. Read these instructions and understand all requirements, including requirements of authority having jurisdiction, before beginning installation. Installation not complete until appliance operation is verified per Installation, Operation & Maintenance Manual provided with boiler.

## ⚠ CAUTION

Laceration, burn hazard. Metal edges and parts may have sharp edges and/or may be hot. Use appropriate personal protection equipment to include safety glasses and gloves when installing or servicing this appliance. Failure to follow these instructions could result in minor or moderate injury.

### Combustion Cover Replacement

1. Follow instructions To TURN OFF GAS TO APPLIANCE found on Operating Instructions label on boiler or in Installation, Operation & Maintenance Manual. Verify all electrical power to boiler is turned off.

## ⚠ WARNING

Electrical shock hazard. Turn OFF electrical power supply at service panel.

2. Verify all power to boiler is turned OFF at service panel.
3. Follow Installation, Operation & Maintenance manual to remove front jacket panel.

## ⚠ WARNING

Burn hazard. Verify unit has cooled before servicing. Use appropriate personal protection equipment.

4. Inspect combustion chamber through sight glass. Verify flame is not present.
5. Verify unit has cooled before servicing.
6. Remove (4) four screws from external heat exchanger cover. See Figure 1. Lift cover up from bottom and pull forward.
7. Remove (4) four screws holding inner combustion cover with insulation.
8. Install new inner combustion cover and insulation in place. Secure with 4 screws.

9. Install new outer combustion cover in place. Take care to ensure left and right sides are tucked behind the vertical rails. Secure with 4 screws.
10. Turn Gas and Electric to boiler on.
11. Resume operation using OPERATING INSTRUCTIONS found on Operating Instructions label on boiler or in Installation, Operation & Maintenance Manual.
12. Install front panel. Secure in place with removed screws.
13. Verify proper operation.

**Figure 1 - Heat Exchanger Covers**

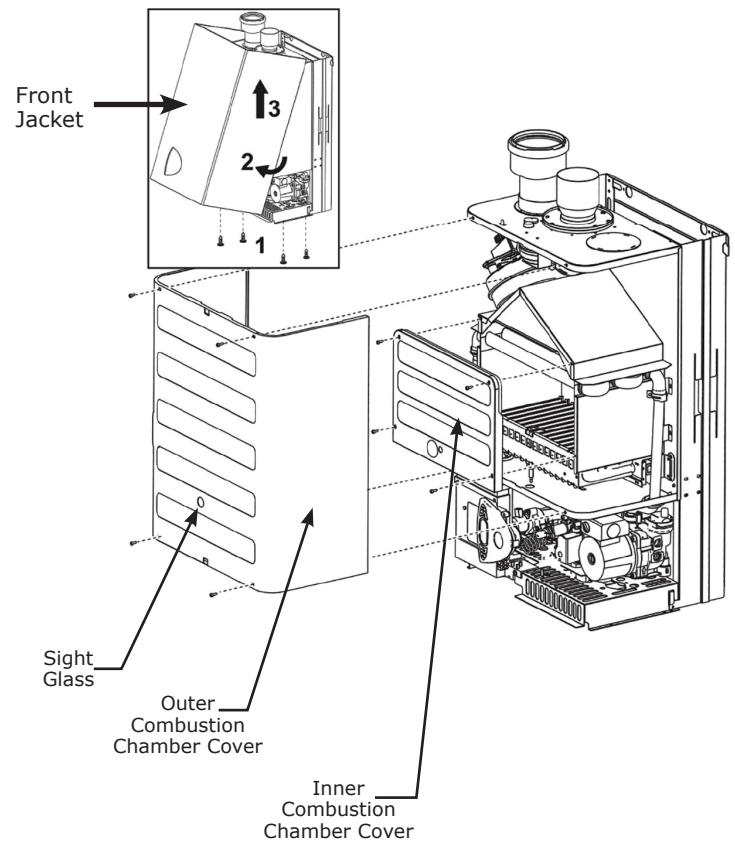

Illustrations are a depiction of the boiler for general location of parts and are subject to change without notice.